

QUALITY SPECIFICATIONS



KITCHEN

Fitted kitchen equipped with **Bosch** brand oven, induction hob and extractor fan.

Kitchen units by the Italian manufacturer, **Venetta Cucine**, with matt beige lacquered doors and worktop and splashback in **Silestone Northern White**.

Stainless steel single sink with mixer tap, model Talis by **HANSGROHE**.



BATHROOMS

Both the main bathroom and the second bathroom will have a Hasviq 100 sink on Scala 02 model unit, in ecru, both by **Visobath** and with taps by **HANSGROHE**, model Focus.

Suspended WC by Ideal Standard in white, wall-hung model Tesi, in main bathroom and back-to-wall model Tesi in second bathroom.

SALONI brand porcelain tiles and flooring, model Petralava in Ivory, measuring 75x75cm with Lappato finishing.

With the aim of maximising comfort as well as the aesthetic appearance of the bathrooms, we opted to install **recessed taps** in the showers, model IBOX by **HANSGROHE**. Shower tray at floor level with glass shower screen.



FLOORING

The same porcelain tile has been chosen for all interior floors in the dwelling, model Petralava by the **SALONI** brand, in ivory, 75x75cm format with Lappato finishing and with skirting tiles from the same brand and model.



WOODWORK

The main access door to the dwelling is a security door in aluminium with high resistance to corrosion by Aludoor brand with internal door frame by **Extrugal** and a white lacquered finish to the interior.

Moulded interior doors in white, model Nova 101, manufactured by **Moinsa**. Fitted wardrobes with a luggage shelf and hanging rail will have the same characteristics. Interiors will have a melamine veneer.

Windows and patio doors with thermal break and white lacquered finish by the **Cortizo** brand. Insulating double glazing throughout the dwelling, with safety glass to living room patio doors.

Insulating double glazing 4+4 Guardian Sun/air chamber/3+3 to living room windows, 6 Guardian Sun/air chamber/3+3 to bedroom windows, 4+4 Guardian Sun/air chamber/3+3 mate to utility room windows.

Lacquered aluminium roller blinds to bedrooms, with 45mm slats and motorised drive.

Security glass panelling to the terraces.

FACILITIES

Every home will have an air-to-air heating / air conditioning system installed, with split wall-mounted inverter technology units by Panasonic, model CS-TE42TKEW.

Aerothermal system to produce hot water with capacity for 110 litres.

Light switches suitable for smart home installations by Hager, from the Berker series, in silver colour.

Telephone points and TV-TDT-SAT points in living room and bedrooms.

Terrestrial TV antenna and four polarity parabolic antenna.



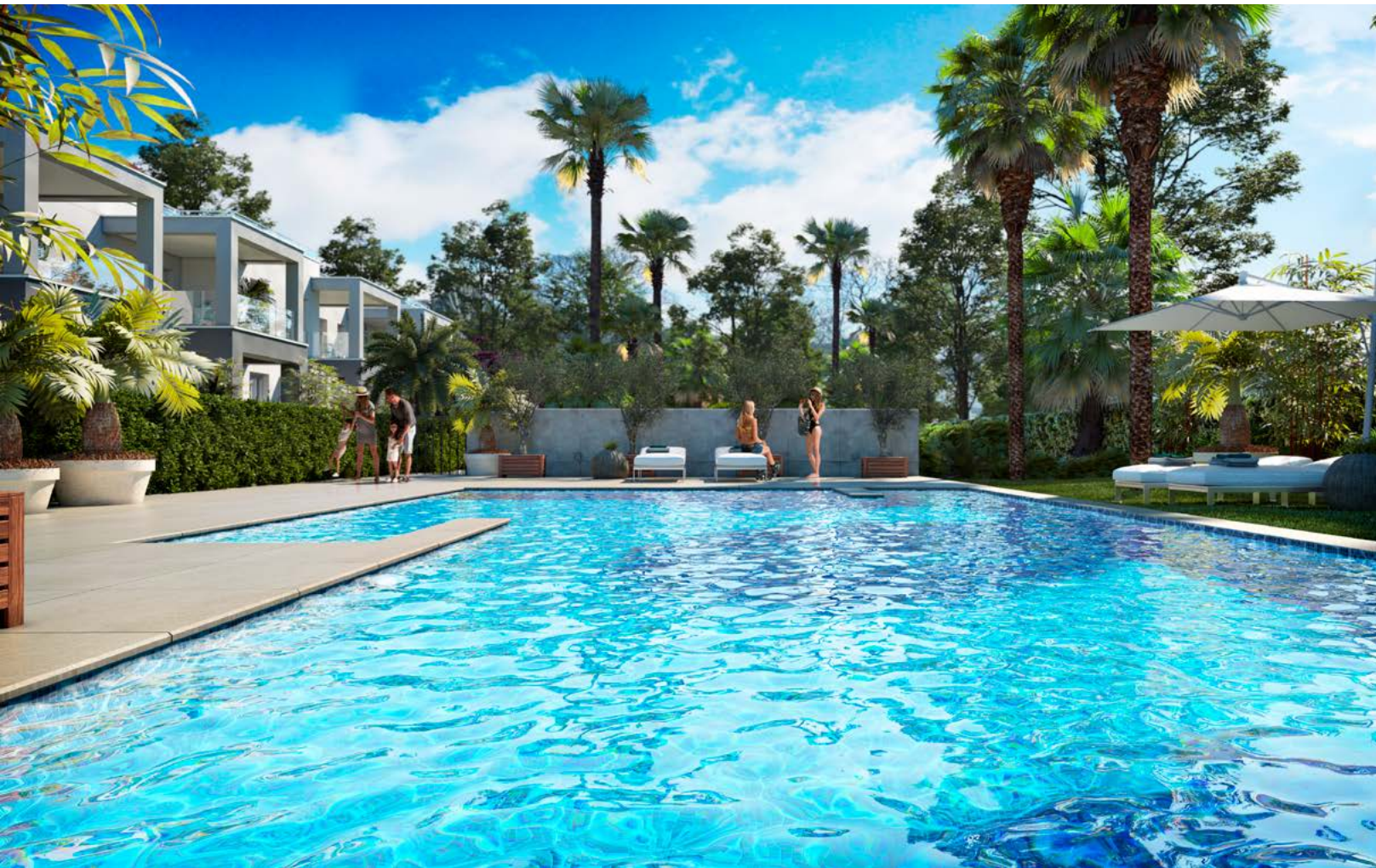

EXTERIOR

Communal areas have a swimming pool with shower and lighting, as well as landscaped garden areas with irrigation system installed.

The poolside solarium area will be finished with Formentor grey porcelain floating tiles in 60x60cm format.

Private gardens separated by hedging.

Every home includes an outdoor parking space, with preinstallation of charging station for an electric vehicle, and a communal storage room at basement level.

TAYLOR WIMPEY DE ESPAÑA S.A.U.
reserves the right to modify or change the
materials, models and distribution of these
specifications and plans with the purpose of
improving the project in compliance with the
criteria of the project technicians.

